

Paper Blossoms

Mold Paper to Create 3D Realistic Flowers

How To Make an Azalea

Punch
Shape
Assemble

Azalea Supplies

Punches:

- 2 shapes from Floriano 64002 in Berrylicious
- 1 shape from Starflower 64005 in Safari
- 1 shape from Starburst 64512 in Berrylicious
- 2-4 shapes from Birch Leaf 64502 in Safari

Tools:

- Paper Tool Kit and Case 65800
- Craft Molding Mat 65900

Additional:

- Berrylicious and Safari Cardstock (Bazzill Basics)
- White Color Box Ink pad (Clearsnap)
- Tim Holtz Distress Ink: Victorian Velvet and Peeled Paint (Ranger)
- Ink Blending Tool (Ranger)
- Wine Red Tombow Marker #837
- Fabri Tac Glue (Beacon Adhesives)
- Non-stick Craft Mat or Scrap Paper
- Detail Scissors



Photo images are for technique demonstration only. Flower petals may not match this project.

Technique #1 – Shaping

Place a punched shape on the Craft Molding Mat (McGill #65900) and press down with the large 8mm ball stylus. (McGill Paper Tool Kit #65800) Move stylus around in small circular motions to soften card stock, making it easier to manipulate. The paper will curl.

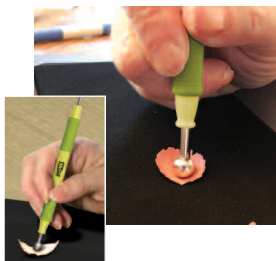

Technique #2 – Pinching

Center the Tweezers, (McGill Paper Tool Kit #65800), over the narrow end of the shape. With thumb and index finger, gradually pinch the paper around the tweezers. This prepares petal for attaching to the flower base.

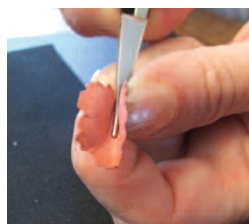

Technique #3 – Bending

Hold the pinched end of the shape between finger and thumb. Use the Tweezers to grasp the side of the shape and roll it back to form the natural curve of a petal. Repeat on other side to complete petal.



Technique #4 – Cupping

With the shape on the mat, use the 8mm stylus (or smaller, if shape is small) placed at a 90° angle to the paper. Press down and roll the stylus around in the center of the shape until it cups up. Cupping creates the flower base that petals attach to in the assembly of the flower.

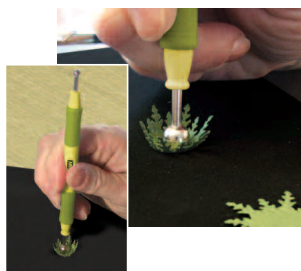

Azalea Assembly

(Techniques described at left)

Cut both Floriano shapes into separate petals for 10 total petals. Rub white ink on the round end of each petal. Use the ink blending tool to rub Victorian Velvet ink on the pointed end of each petal.

Place Floriano petal shapes onto the Craft Molding Mat. Follow Techniques #1, #2, #3 to shape the petals. Set aside.

Next, place the Starflower shape on the Craft Molding Mat. Follow Technique #4 to form a cup that becomes the base to attach petals and leaves.

Place a spot of glue on scrap paper or a non-stick craft mat. Dip the narrow end of the first 5 petals into glue and adhere to the cupped Starflower arms. Continue with the next 5 petals offsetting them in between the first layer of petals. [Add glue in small amounts as needed.

Caution: Don't use glue on or over the Craft Molding Mat. It needs to stay clean and dry.]

Color both sides of the round tips on the Starburst shape with the Wine Red marker. Place the Starburst on the Craft Molding Mat, follow Technique #4 to form a cup. Pinch the base of the Starburst to make it tighter. Glue into the center of the flower.

Place 2-4 Birch Leaf shapes on the Craft Molding mat. Use Technique #1 to form the leaves. Use the 1mm stylus to add thin veining details to each leaf.

Use the Ink Blending Tool to rub Peeled Paint ink onto each leaf to add color detail.

Glue leaves to each side of the flower to complete the Azalea.



McGill
INCORPORATED®

www.mcgillinc.com